

Former Architect Space = *HIGHLY IMPROVED*

5420 N. 16th Street

Phoenix, Arizona



FEATURES:

8,455 to 16,920 SF For Lease

Clean, Functional Space on 16th Street

Former Architect Office

Clean, Functional, Beautiful, Economical

Parking Ratio: 4/1000sf (50 Shaded)

100% Remodeled

Many Nearby Amenities

500 Feet from Highway 51 = Quick Access

Highend Training and Soundproof Zoom Rooms

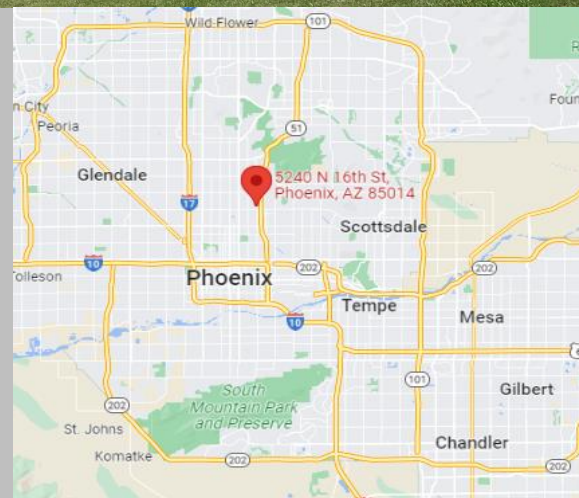

Full Service Rents - Call for Rates & Tour

John Asher

(602) 432-4336

Asher@AT-RES.com



No warranty or representation, expressed or implied, is made to the accuracy of the information contained herein and same is submitted subject to errors, omissions, change of price or other conditions. You and your advisors should conduct a careful, independent investigation of the property to determine to your satisfaction the suitability of the property for your needs.

Former Architect Space = **HIGHLY IMPROVED**

5420 N. 16th Street
Phoenix, Arizona

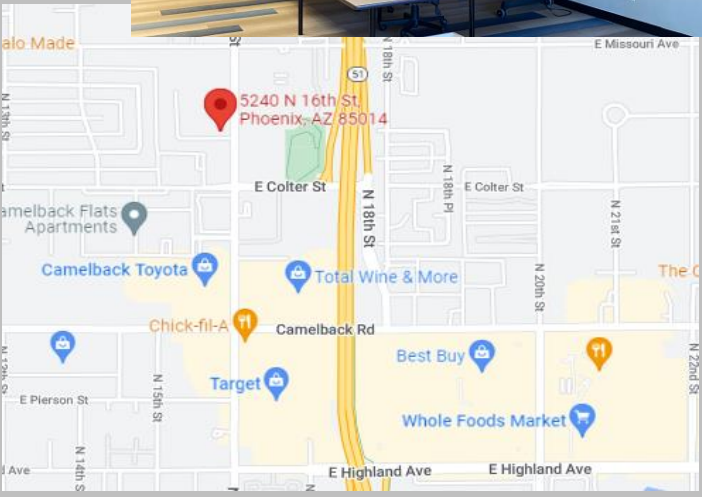
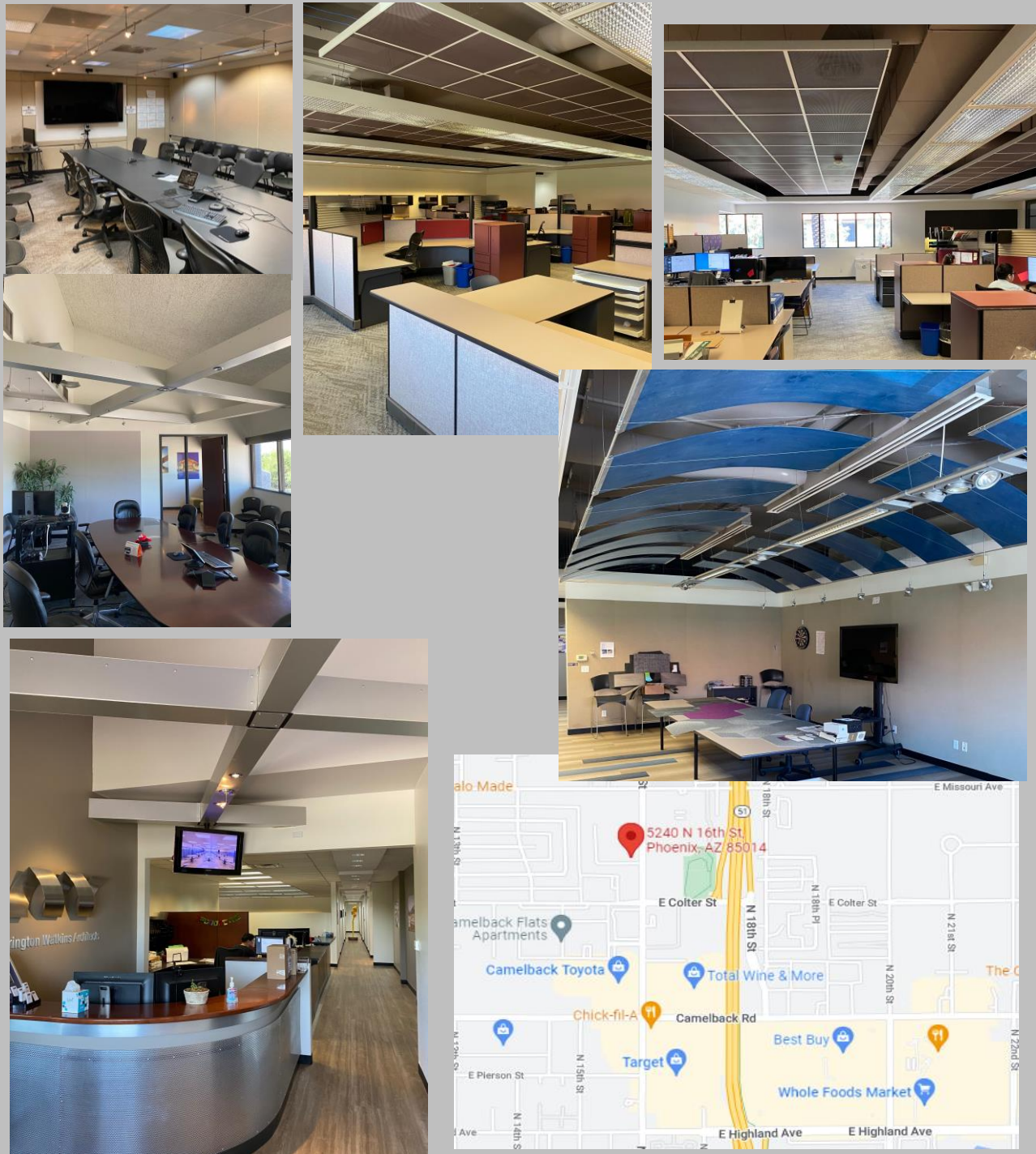

Half or Entire Building Available

John Asher
(602) 432-4336
Asher@AT-RES.com



No warranty or representation, expressed or implied, is made to the accuracy of the information contained herein and same is submitted subject to errors, omissions, change of price or other conditions. You and your advisors should conduct a careful, independent investigation of the property to determine to your satisfaction the suitability of the property for your needs.

Former Architect Space = *HIGHLY IMPROVED*

5420 N. 16th Street

Phoenix, Arizona

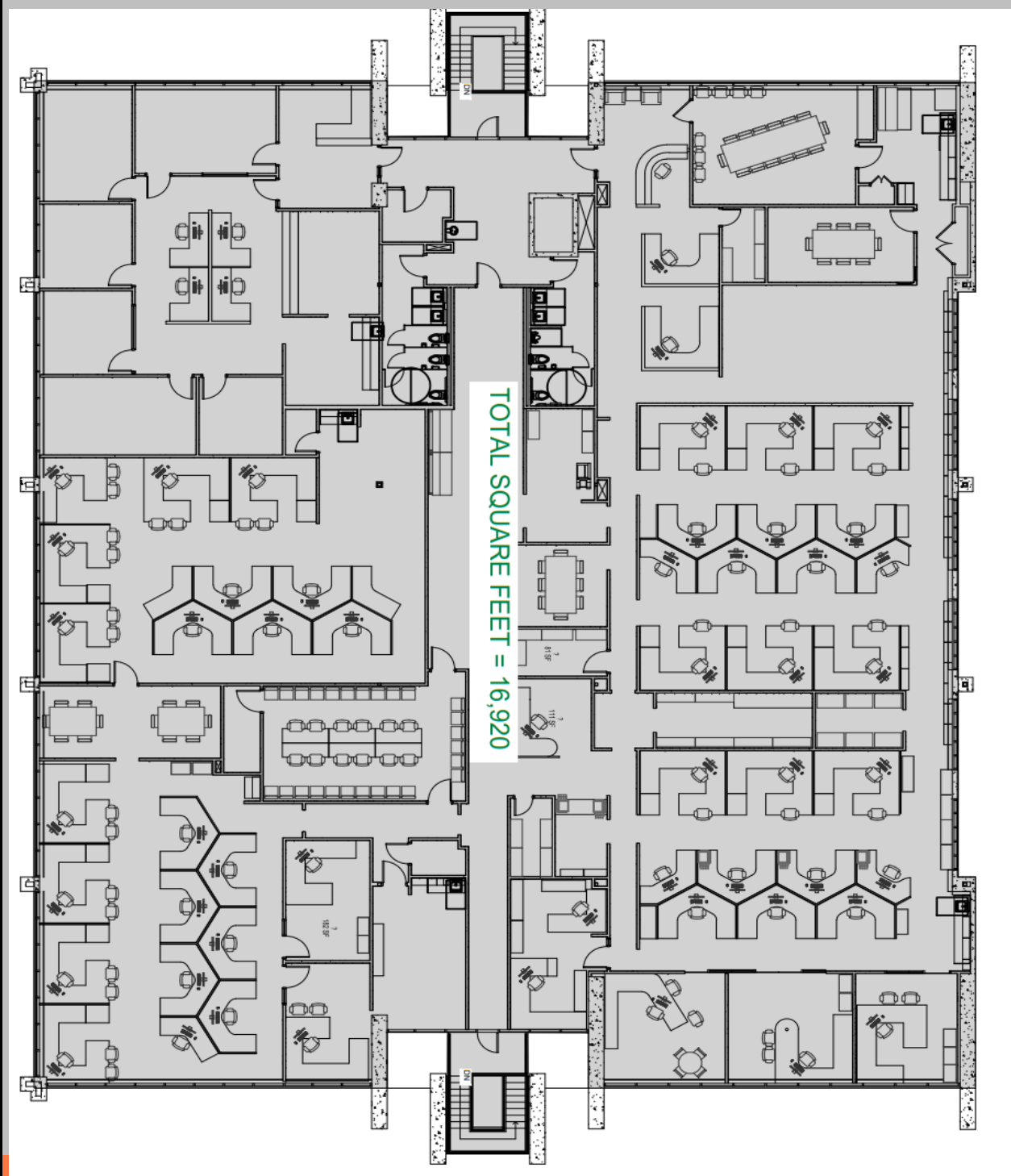

John Asher
(602) 432-4336
Asher@AT-RES.com



No warranty or representation, expressed or implied, is made to the accuracy of the information contained herein and same is submitted subject to errors, omissions, change of price or other conditions. You and your advisors should conduct a careful, independent investigation of the property to determine to your satisfaction the suitability of the property for your needs.